



The Teatro Repower is the Milanese stage for the big musicals and is also available for events such as conventions, congresses, promotional activities and television productions, as well as pre and after show receptions.

With 1730 places - on a single level, over a sloping surface, with ample space between each row of seats, in order to guarantee the maximum level of comfort, visibility and sound quality for all spectators - the Teatro Repower is also suitable for smaller events, thanks to its impressive modularity.

The vastness of the stage (800 sqm) and the wealth of technical options, which were designed to host the most significant theatrical productions, ensure that the requirements of all major events are fully met. The venue offers numerous suspended structures, 18 changing rooms and a control room.

Amongst the secondary spaces, apart from the large and elegant foyer, which has two refreshment points and a cloakroom area, the Broadway Hall can host about 50 people in a private and highly atmospheric environment. The Hall is also suited for organising quality catering services.

The Teatro Repower is situated opposite the Mediolanum Forum and has a large parking area. The theatre will soon be reachable through a dedicated stop of line 2 of the Milanese Underground.



Teatro Repower

Via G. Di Vittorio, 6 - 20090 Assago (MI) - Tel. +39 02 488571 - Fax +39 02 48844898 - www.forumnet.it

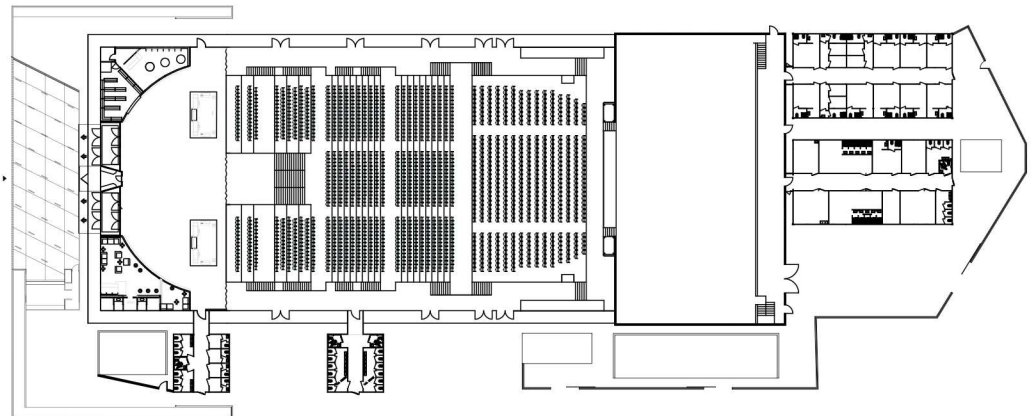

AUDITORIUM: 1,730 PLACES

DEPTH OF STAGE: 20 M; WIDTH 40M

PROSCENIUM: WIDTH 14.50 M - HEIGHT 6.30 M

ORCHESTRA PIT: WIDTH 10 M - DEPTH 3 M

**WORKABLE IRON TRELLIS: WIDTH 21 M - DEPTH 20 M
HEIGHT FROM THE STAGE FLOOR 13.70 M**

TRUSSES IN THE AUDITORIUM: 2 BRIDGES FOR LIGHTS, DISTANCE FROM STAGE 4 M - 7 M WITH THREE SPOTLIGHTS; 2 FIXED TRUSSES, CLOSE TO THE STAGE AND IN THE MIDDLE OF THE AUDITORIUM

THEATRE EQUIPMENT: ROPES, BACKCLOTH SUPPORT, BLACK STAGE CURTAINS, BLACK CEILINGS, BLACK BACKGROUND, DANCE MAT 14 M X 12 M

**LIGHTS: ELECTRIC CHARGE FROM TRANSFORMER CABIN WITH TERMINAL BLOCK - 200 KW; VOLTAGE: 380 V + N + T;
POWER DISTRIBUTION BLOCKS: ELECTRICAL CHARGE OF POWER DISTRIBUTION BLOCKS - 180 KW; NUMBER OF POWER DISTRIBUTION BLOCKS: 3X 125 A - 380 V, 3X 63A - 380 V, 3X 32 A - 380 V, 3X 32 A - 220 V, 60X 16 A - 220V**

AUDIO: POSSIBLE TO SUSPEND AUDITORIUM SPEAKERS ON TWO TOWERS, TO THE SIDE OF THE STAGE, WITH A LOAD BEARING CAPACITY FOR EACH TOWER OF 600 KG

**CONTROL ROOM: AT THE REAR OF THE AUDITORIUM;
SPACE AVAILABLE: DEPTH 5 M - WIDTH 8 M**

CHANGING ROOMS: 2 SINGLES - LEAD ACTORS - SINK, SHOWER, WC; 6 SINGLES - SUPPORTING ACTORS - SINK, SHOWER, WC; 7 QUADRUPLES - SINK, SHOWER, WC; 2 MULTI-CHANGING ROOMS - SINK, SHOWER, EXTERNAL WC; 1 MAKE-UP ROOM; 1 TAILOR'S ROOM